

Please read and save these instructions. Read carefully before attempting to assemble, install, operate or maintain the product described. Protect yourself and others by observing all safety information. Failure to comply with instructions could result in personal injury and/or property damage! Retain instructions for future reference.

# Action Heavy Duty Siphon Pump

## Description

Action Heavy Duty Siphon Pump is designed to deliver 7 GPM. It is made of all PVC with a PVDF ball valve. Comes with a 41" PVC discharge hose. This model is designed to fit 15, 30 and 55 gallon barrels and drums with a standard 2" bung opening. PVC 2" bung adapter is included.

## Specifications

Flow rate per stroke . . . . .	7 GPM
Mounting. . . . .	See Bung Adapter
Inlet. . . . .	1-1/2" OD
Outlet . . . . .	1-1/4" OD
Bung Adapter. . . . .	2" PVC
Suction Tube . . . . .	41" PVC
(Length & Material)	
Packing Gland . . . . .	PVC
Wetted Parts . . . . .	PVC
SSU . . . . .	SAE 40W Oil @ 70°F (about 4,000 SSU)
Max. Temp. . . . .	120°F

## General Safety Information

**▲ WARNING** *It is the responsibility of the user to operate the pump in conformance with the OSHA rules for dispensing liquids. Pump containers should be grounded when using with flammable liquids to avoid static electricity. Pump should be washed out before usage since processing lubricants could contaminate the fluids.*

1. When using a hand pump (especially when pumping flammable, combustible or hazardous liquids) follow all electrical and safety codes, as well as the United States Occupational Safety and Health Act (OSHA), most recent National Electrical Code (NEC), National Fire Protection, Inc. \* (NFPA) Code 30 (Flammable and Combustible Code), NFPA 56A (Standard for use of Inhalation Anesthetics), NFPA 77 (Static Electricity), NFPA 78 (Lightning Protection Code), NFPA 80 (Standard for Fire Doors and

Windows), NFPA 251 (Standard Method of fire Test of Building Construction), NFPA 704 (Identification of the Fire Hazards of Materials), other NFPA codes, local codes and ordinances, as needed in a particular application

2. Know the pump application, limitations, and potential hazards. The "WARNING" statements indicate potential hazardous conditions for the operator or equipment. TAKE NECESSARY STEPS TO PROTECT PERSONNEL AND EQUIPMENT.

**NOTE:** Pump should only be used with liquids compatible with pump component materials. Consult PUMP CHEMICAL COMPATIBILITY CHART and PUMP SPECIFICATIONS. Also, the chemical supplier should be consulted regarding any questions of chemical compatibility, proper and safe use and handling of chemical. Misapplication of pump or use of non-compatible liquids will void warranty.

**▲ WARNING** *In order to properly use this product, familiarize yourself with this pump and also with the liquid (Chemical, etc.) that is going to be pumped through the unit. Although this pump suitable for many liquids it is NOT suitable for all liquids!*

3. Pumping hazardous, flammable, or combustible liquids should only be done in buildings, rooms, or areas suited for this purpose. (See NFPA 30, NFPA 78, NFPA 80, NFPA 251, NFPA 704, other suitable NFPA codes, OSHA, insurance companies, local codes and ordinances.)

**▲ WARNING** *When filling cans, drums, etc. with combustible or flammable liquids, both container pumping from and container pumping to, should be bonded and grounded to dissipate possible accumulations of static electricity (Refer to NFPA 77 for specific details and further details).*

# Action Heavy Duty Siphon Pump

## General Safety Information (Continued)

(\*) Any of the NFPA Codes can be obtained from : National Fire Protection Association, Inc., Batterymarch Park, Quincy, MA 0269, telephone 1-800-344-3555. Write or call for listing and prices.

**▲ WARNING** *Removal of outer garments in work areas where there may be flammable or explosive liquids, which are ignitable with low electrical energy, can be fatal and/or cause property damage (Refer to NFPA 56A, and NFPA 77, for further details).*

4. The "WARNING" and instructions for gasoline below pertain not only to gasoline, but to any flammable, combustible or hazardous fluid.

**▲ WARNING** *Gasoline is a highly flammable fuel. The improper use, handling or storage of gasoline can be dangerous. Prevent accidents by following these safety rules:*

- a. Use gasoline only as a fuel, never as a cleaning fluid.
- b. Use only an approved container to hold or store gasoline. Never store gasoline in familiar containers such as milk containers or soda pop bottles.
- c. Store gasoline in a cool location, out of the reach of children. Never store gasoline near heat or an open flame.
- d. Provide a fire extinguisher nearby when working with gasoline. Be sure extinguisher is in operating condition — check the pressure gauge or indicator. Be familiar with its proper use. Consult local fire department for the correct type of extinguisher for your application. Extinguishers rated ABC by the National Fire

Protection Association are appropriate for most applications.

- e. Provide positive shut-off valves on all permanent fuel supplies. Fuel lines must be of steel piping, adequately secured, and free from leaks.
- f. Provide adequate ventilation, and clean up any spills when handling or pumping flammable liquids.
- g. POSITIVELY NO SMOKING!
5. Do not use torches or apply fire or flame to this pump for any reason.
6. Secure the discharge line before starting the pump. An unsecured discharge line will slip, possibly causing personal injury and/or property damage.
7. Do not over tighten nonmetallic threaded fittings. One full turn past hand tight is usually enough to prevent leakage. Teflon sealant tape should be used on all threaded joints, including the spout.
8. Check hoses for weak or worn condition before each use, making certain that all connections are secure.
9. Periodically inspect pump and system components. Perform routine maintenance as required.
10. Drain all liquids from the system before servicing.

**▲ WARNING** *Any pump used to transfer flammable liquids must be stored in a well ventilated area after use.*

### 11. Personal Safety

- a. Wear safety glasses at all times when working with pump.
- b. Wear a face shield, proper apparel and suitable respiratory equipment, when pumping

hazardous chemicals.

- c. Keep work area clean, uncluttered, and properly lighted, replace all unused tools and equipment.
- d. Keep visitors at a safe distance from the work area.
- e. Make workshop childproof, with padlocks, master switches, and by removing starter keys.

**▲ WARNING** *Failure to follow all general safety information can result in a fatality, personal injury and/or property damage!*

## Installation

1. Always carefully read, and follow the pump operating instructions.
2. Attach hose (Ref. No. 2) and hose clamp (Ref. No. 1) firmly to discharge spout.

**▲ CAUTION** *Make sure the clamp is securely tightened.*

3. Attach thumb screw (Ref. No. 4) through bung hole (Ref. No. 3), tighten wing nut (Ref. No. 5).
4. Prior to use, inspect your pump to make sure all fittings are tight and consult your operating manual for safety instructions.
5. Adjust pump to desired height and tighten thumb screw in adapter by hand. **DO NOT USE A WRENCH OR TOOL TO TIGHTEN THUMB SCREW.**

## Operation

1. Place pump into drum and take bung adapter (Ref. No. 3) and screw clockwise into container, making sure adapter is securely tightened to container.
2. Place pump discharge tube (Ref. No. 2) into container receiving fluid.
3. Tighten thumb screw on bung adapter to hold pump in place.

---

# Model 5000

---

## General Safety Information (Continued)

4. Grip handle (Ref. A) and pull upward several times with half strokes until all air leaves discharge hose and liquid flows continuously through the discharge hose (Ref. No. 2). At that point pull handle completely upward past the discharge port.
5. To stop liquid flow, push handle down below the discharge port.

**⚠ CAUTION** *Liquid flow will not stop if discharge hose is submerged in liquid.*

6. If siphon action stops or slows due to low liquid level in drum, either elevate the drum or operate manually to maintain flow. When discharging thick liquids, you may need to operate manually to discharge liquid.
7. To restart liquid flow, repeat Step 4.

8. If pump is removed from drum, rinse thoroughly in liquid that is compatible with both the pump and fluid. For any questions about chemical compatibility, contact your chemical supplier.
9. Normal moisture buildup will occur on handle shaft but will flow back into container.

## Maintenance

Normal maintenance is not required.

---

## 90-Day Limited Warranty

# Action Heavy Duty Siphon Pump

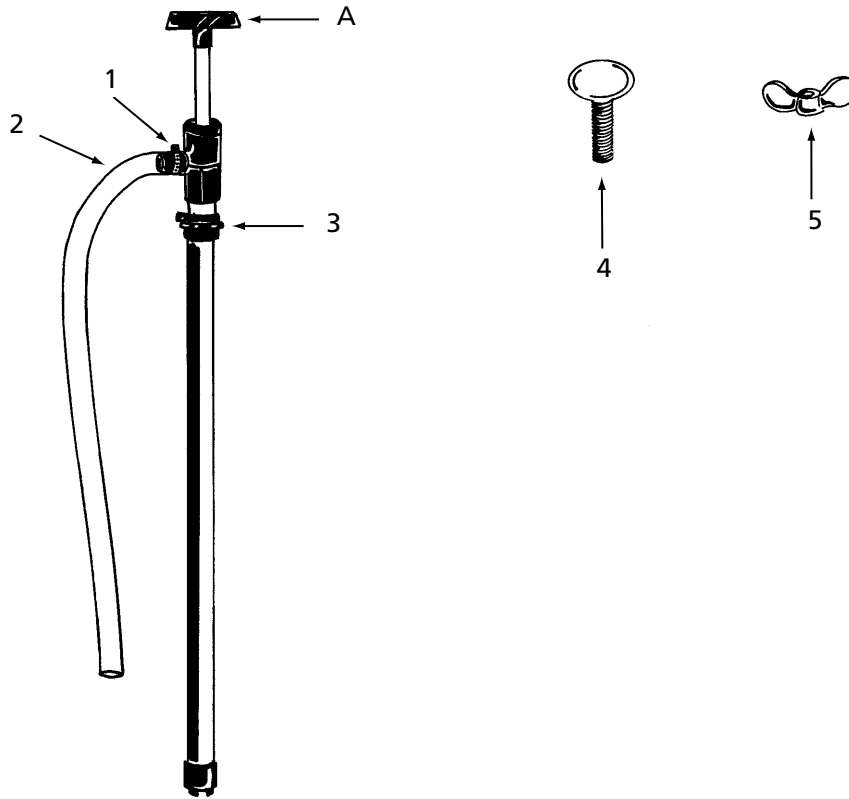

Figure 1 — Replacement Parts Illustration

## Replacement Parts List

Reference Number	Description	Material	Part Number	Quantity
1	Hose Clamp	S.S.	1P416	1
2	Discharge Tube	PVC	423-H	1
3	Bung Adapter	PVC	65001	1
4	Thumb Screw	Steel	1650-19	1
5	Wing Nut	Steel	500-W	1

**NOTE:** For handle (Ref. A) replacement, contact manufacturer.